

# Koo-di

## Stroller Lock

  
www.koo-di.co.uk

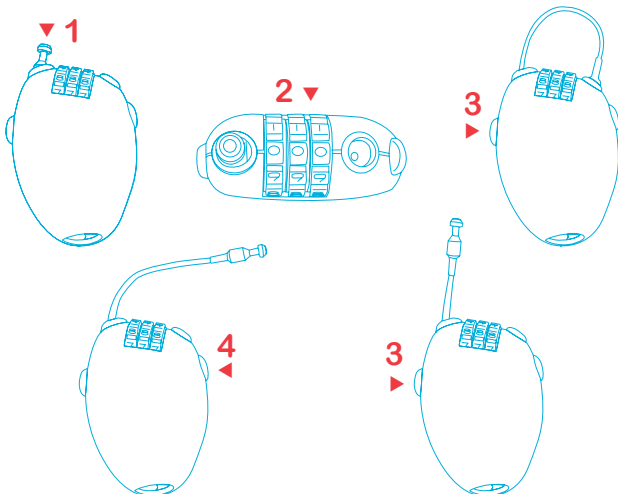

The combination number set in the factory is 0-0-0. You can keep this number or change it as you like.

- Press the metal end of the cable (1) and set the new combination by turning the metal wheels (2). Press the side catch (3) and pull the metal end. The lock is now ready for use.
- Insert the metal end into the slot and then, for security, randomly change the numbers. Use the side catch to adjust the cable if necessary (3).
- To open the lock, set the numbers to the previously defined combination number and press the side button (4).
- To wind the cable up, press the side catch again (3).

W|H|L  
Weybury Hildreth Ltd.  
Bay 1, Building 47 Second Avenue,  
The Pensnett Estate,  
Kingswinford, West Midlands,  
DY6 7UZ. UK.  
email: enquiries@koo-di.co.uk  
tel: 0845 6809276

